

Safety information

- For use in dry, oil free indoor environments only.
- Do not use to link between buildings.
- Not suitable for use in hazardous or explosive environments or next to highly flammable materials.
- Warning – the power adapter contains live parts.
- No user serviceable parts are contained within the modules or the power adapter - do not dismantle.
- Do not use the power adapter if the power adapter case becomes damaged, cracked or broken or if you suspect that it is not operating properly.
- Replace the power adapter with a manufacturer approved type only.
- If you use a power extension cable with the power adapter, make sure the total ampere rating of the devices plugged into the extension cable do not exceed either the cable's ampere rating or that of the wall outlet.
- Ensure that all twisted pair interconnect cables are installed in compliance with all applicable wiring regulations.
- Do not connect the CATx link interface (RJ45 style connector) to any other equipment, particularly network or telecommunications equipment.
- Where possible, avoid laying the twisted pair link cable(s) alongside power cables.
- The modules do not provide ground isolation and should not be used for any applications that require ground isolation or galvanic isolation.
- For correct operation, the local and remote modules must have ground connections. At the computer end, this is achieved by ensuring that the computer that the module is connected to has a ground connection. At the device end, this can be achieved by ensuring that the power supply is connected to a grounded power outlet.

Warranty

Adder Technology Ltd warrants that this product shall be free from defects in workmanship and materials for a period of two years from the date of original purchase. If the product should fail to operate correctly in normal use during the warranty period, Adder will replace or repair it free of charge. No liability can be accepted for damage due to misuse or circumstances outside Adder's control. Also Adder will not be responsible for any loss, damage or injury arising directly or indirectly from the use of this product. Adder's total liability under the terms of this warranty shall in all circumstances be limited to the replacement value of this product. If any difficulty is experienced in the installation or use of this product that you are unable to resolve, please contact your supplier.



C-USB cable extenders

Quick Start

The Adder C-USB modules allow you to extend the distance between a USB peripheral and your computer by up to 100 metres.

The local module connects to a vacant USB port on your computer. You then connect your USB 1.1 or 2.0 peripheral to the remote module which is linked via CAT 5, 5e or 6 cabling to the local module. A power adapter is provided to supply the remote module.

In operation, the C-USB modules remain transparent to allow your USB peripheral to work as expected.

What's in the box

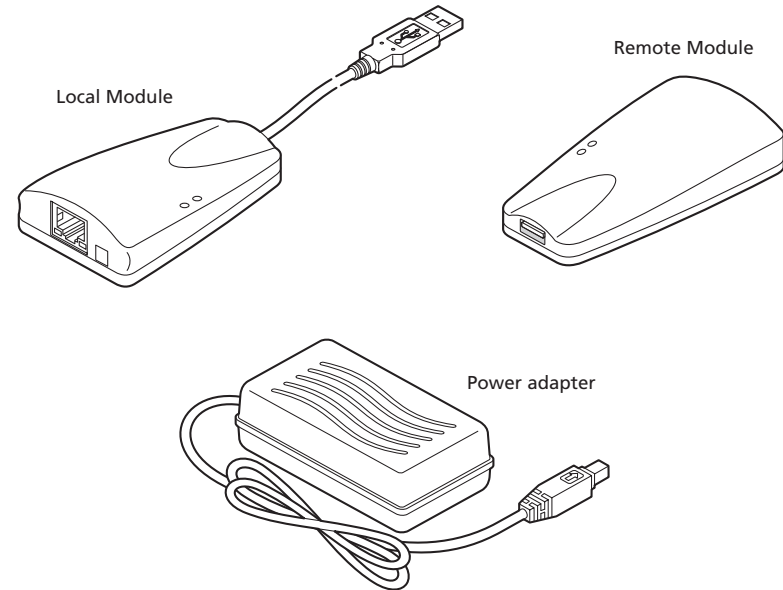

What you may additionally need

CAT 5, 5e or 6 link cable, up to 100m in length



support@adder.com
www.adder.com

Adder Technology Limited,
Technology House,
Trafalgar Way, Bar Hill,
Cambridge, CB23 8SQ,
United Kingdom
Tel: +44 (0)1954 780044
Fax: +44 (0)1954 780081

Adder Corporation,
350R Merrimac Street,
Newburyport,
MA 01950,
United States of America
Tel: +1-888-932-3337
Fax: +1-888-275-1117

Adder Asia Pacific
6 New Industrial Road,
Hoe Huat Industrial Building
#07-01,
Singapore 536199
Tel: +65 6288 5767
Fax: +65 6284 1150

Host computer USB connection

Connect the USB plug of the local module to a vacant port on your computer. The module derives its power from your computer's USB port which must be capable of providing up to 500mA.

Local module

Indicators

Each module has four indicators to provide useful feedback about operation:

- Green link indicator - (adjacent to connector) On when the link to the other module is valid.
- Amber activity indicator - (adjacent to connector) Flashes when data is being transferred.
- Blue Power indicator - On when power is present.
- Green Host indicator - On when installation is correct. Flashes on the remote module if the computer is in suspend mode or if a USB device is not attached.

Link cable

Use only CAT 5, 5e or 6 unshielded twisted pair cabling to a total length **no greater than 100 metres**. The cabling must have a straight-through configuration with no crossovers and must be terminated with 8 conductor RJ45 connectors at both ends. The combined length of any patch cords using stranded conductors must not exceed 10m.

Checking the installation

- On the local and remote units, check that the Power, Host and green link indicators are all on. When information flows, the amber link indicator should flash.
- On the local module, if the blue Power indicator is off, check that your computer is on and the USB connector is correctly attached.
- On the remote module, if the blue Power indicator is off, check that the power adapter is correctly connected and is plugged to a working wall outlet.
- On your computer you can check for the presence of the modules:
Windows PC: Open the Device Manager and expand the entry for the Universal Serial Bus controllers. Check for an entry showing **Generic USB Hub**.
Mac: Open the System Profiler and in the left hand column under Hardware, select USB and inspect the right hand panel. Check for an entry showing **Hub** under the USB High-Speed Bus/USB Bus.

USB device connection

Connect the plug of your USB device to the socket on the remote module.

Remote module

Power adapter connection

Connect the supplied power adapter to the input socket on the remote module and plug the adapter into the nearest wall outlet.

